



- Notes:
- Vertical Datum: AVD 46
 - Origin: RM XXVI LT 130284 (CPN9)
RL: 23.80 m
 - Horizontal Datum: Mt Eden Circuit
 - Origin: ALP 16 DP 397930 (EE3X)
851997.08 mN
396121.70 mE
 - Contour Interval is 0.5m
 - Location of underground services need to be confirmed onsite prior to any works
 - This plan is not intended for any use beyond its original purpose.
 - Aerial Photo taken 21/06/2021
 - Position of some site features are taken from the Aerial Photograph



16 Mill Lane, P.O.Box 107, Warkworth 0941, 09 425 8950
www.buckton.co.nz, surveyors@buckton.co.nz

Prepared for:
Rose Stanhope

Topographical Survey of Lot 2 DP 91288

Address :
124 Mahurangi East Road, Snells Beach

This document is the property of Buckton Consulting Surveyors Ltd., and is not to be reproduced without their written authority.

Scale:
1:750 (A3)

Job: 8665	Date: 23/06/2021	Drawn: TJ	Reviewed: GH
---------------------	----------------------------	---------------------	------------------------

Drawing: TP 01	Rev: -	Sheet: 2 of 2
--------------------------	------------------	-------------------------



Memorandum of Easements			
Purpose	Shown	Servient Tenement (Burdened Land)	Dominant Tenement (Benefited Land)
Right of Way	Ⓐ	Lot 7 hereon	Lot 6 hereon
	Ⓑ	Lot 10 hereon	Lots 11 & 12 hereon
	Ⓒ	Lot 19 hereon	Lot 20 hereon

- Notes:
- Areas and dimensions are approximate only and are subject to survey.
 - Zone: Auckland Unitary Plan Operative in Part
 - Residential Large Lot
 - This plan is for Resource Consent Purposes only.
 - This plan is subject to geotechnical, planning, engineering, ecological, urban design, landscape, traffic analysis & design
 - EB = Easement Boundary
 - indicates 8m x 15m building site
 - Total RT Area : 1.6126 ha

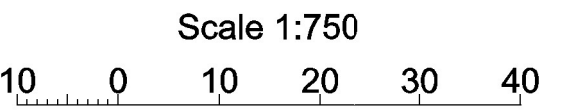

16 Mill Lane, P.O.Box 107, Warkworth 0941, 09 425 8950
www.buckton.co.nz, surveyors@buckton.co.nz

Applicants :

Silver Hill Ltd
Comprised in RT NA48B/1003

Address :

124 Mahurangi East Road, Snells Beach

This document is the property of Buckton Consulting Surveyors Ltd., and is not to be reproduced without their written authority.

Scale: 1:750 (A3)

Job: 8665	Date: 2/09/21	Drawn: JU	Reviewed: ARH
Drawing: SP 03	Rev: -	Sheet: 2 of 2	

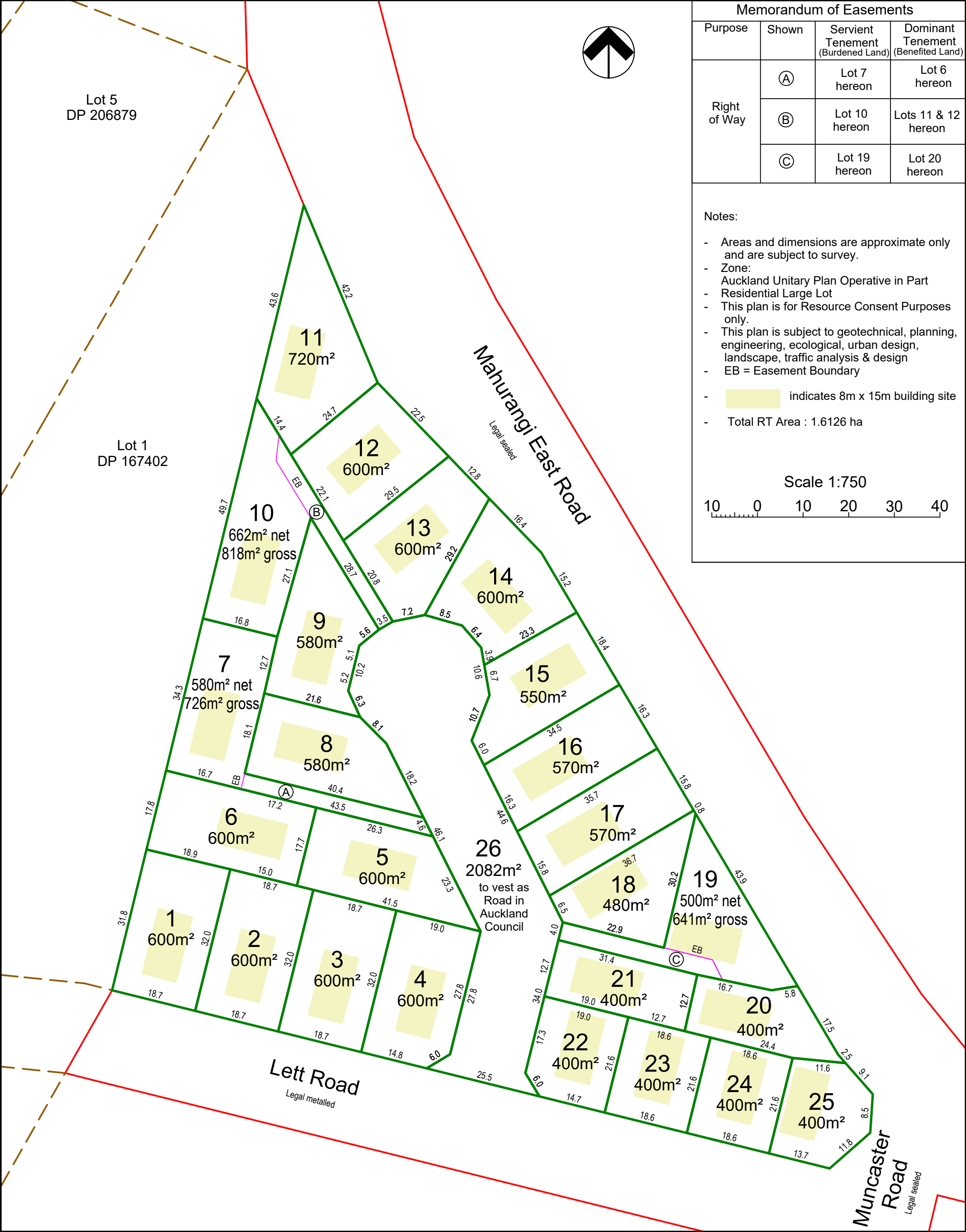

Memorandum of Easements			
Purpose	Shown	Servient Tenement (Burdened Land)	Dominant Tenement (Benefited Land)
Right of Way	Ⓐ	Lot 7 hereon	Lot 6 hereon
	Ⓑ	Lot 10 hereon	Lots 11 & 12 hereon
	Ⓒ	Lot 19 hereon	Lot 20 hereon

- Notes:
- Areas and dimensions are approximate only and are subject to survey.
 - Zone: Auckland Unitary Plan Operative in Part
 - Residential Large Lot
 - This plan is for Resource Consent Purposes only.
 - This plan is subject to geotechnical, planning, engineering, ecological, urban design, landscape, traffic analysis & design
 - EB = Easement Boundary
 - indicates 8m x 15m building site
 - Total RT Area : 1.6126 ha

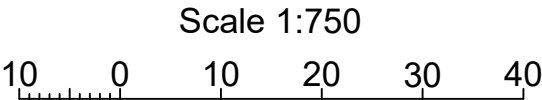

16 Mill Lane, P.O.Box 107, Warkworth 0941, 09 425 8950
www.buckton.co.nz, surveyors@buckton.co.nz

Applicants :

Silver Hill Ltd
Comprised in RT NA48B/1003

Address :

124 Mahurangi East Road, Snells Beach

This document is the property of Buckton Consulting Surveyors Ltd., and is not to be reproduced without their written authority.

Scale: 1:750 (A3)

Job: 8665	Date: 2/09/21	Drawn: JU	Reviewed: ARH
Drawing: SP 03		Rev: -	Sheet: 1 of 2